

# KENT COUNTY PLANNING SERVICES

## FINISHED BASEMENT WALL SECTION

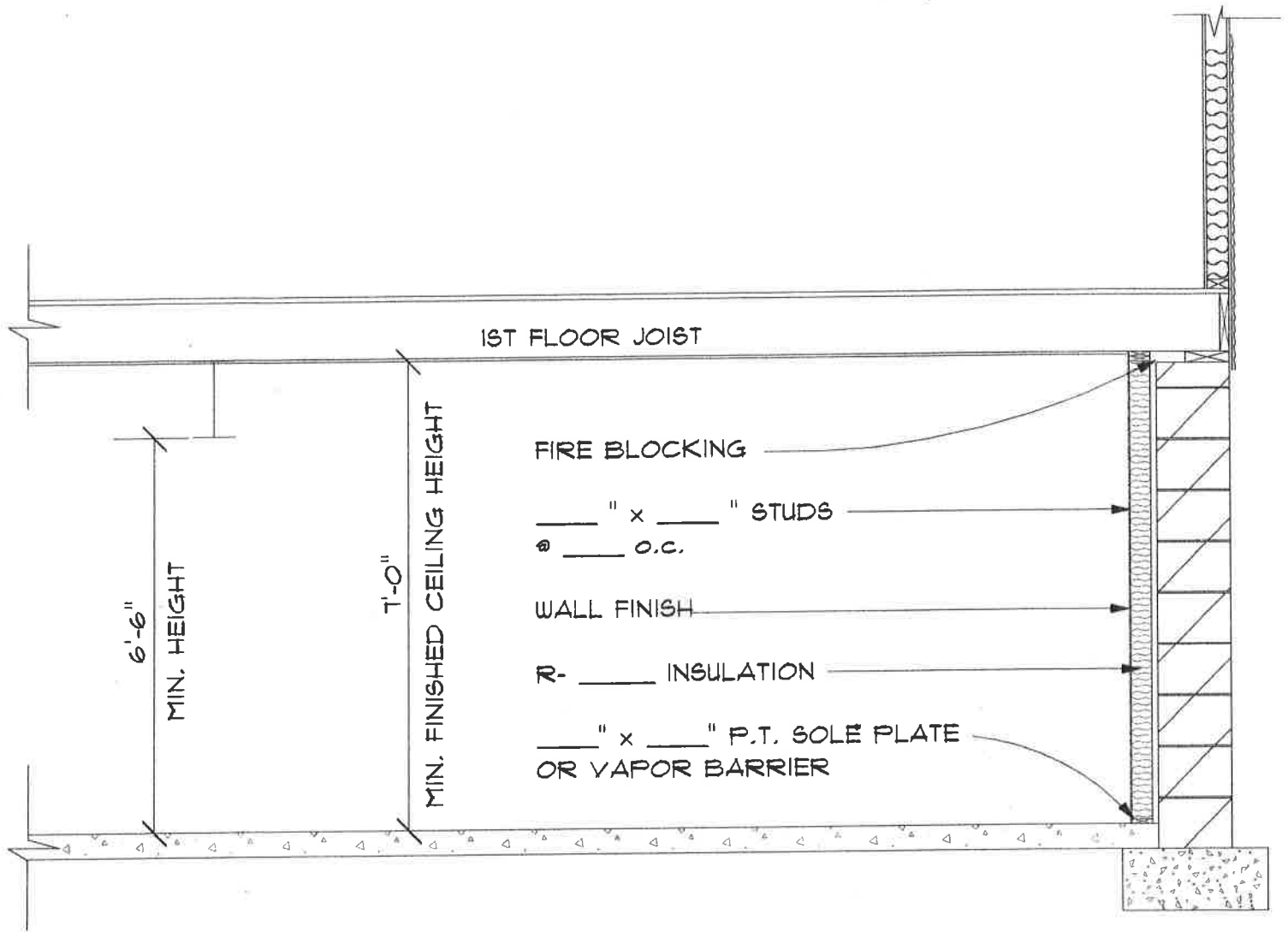

### FILL IN ALL APPLCABLE SPACES

Finished ceiling height may not be less than T'-0".  
The required height shall be measured from  
the finished floor to the lowest projection from the ceiling.

#### EXCEPTION:

Beams or girders spaced not less than 4 feet on center  
may project not more than 6" below the required ceiling height.

# Finished Basement Floor Plan

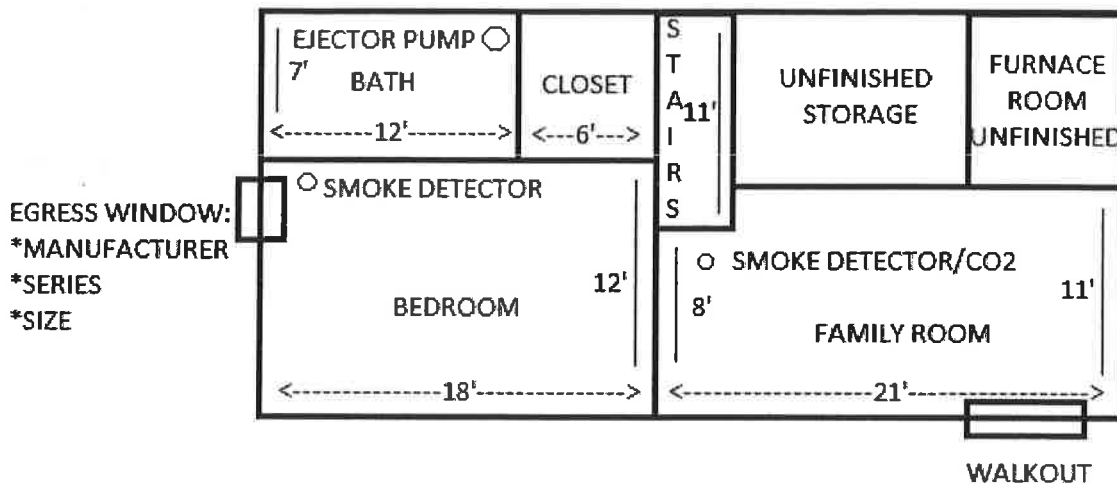

- Must show entire basement including unfinished areas.
- Label dimensions of all rooms to be finished.
- Note the location of a means of egress (window, walkout or bilco door). If there is no means of egress a permit will be required to construct one.
- Note the location of smoke detector.
- Label intended use of spaces to be finished (i.e. bedroom, bathroom, family room).
  - If creating a bedroom:
    - Note the location of a smoke detector inside the bedroom.
    - Note the location of a smoke/carbon monoxide detector outside the bedroom within 10 feet of the bedroom door.
    - Note the location of a means of egress within the bedroom (window, walkout or bilco door).
      - If using an egress window please include manufacturer, series and size of window.
  - If creating a bathroom please note the location of the ejector pump and back flow perimeter.